



# NSPMA's 2026 Conference / EXPO

## Date/Time:

Sun., April 26 - Wed. April 29

Coference check-in opens  
Sunday, April 26th (3pm-4:30pm)

## Location:

Kansas City Marriott Downtown  
200 West 12<sup>th</sup> Street  
Kansas City, MO 64105

## Wifi:

Network:  
Password: NSPMA2026

## Our Keynote Speaker:



### Anne Birky

OSFMA - President  
Bend-La Pine Schools, OR

Resilience After Stroke;  
Overcoming Adversity,  
Reclaiming Purpose  
and Leading Through  
Recovery



# Program

## Sunday April 26th

### Day 1 - Travel / Arrive

**11:00 AM -  
3:00 PM**

NSPMA Board Meeting  
*Truman A (closed meeting)*

**3:00 PM -  
4:30 PM**

Conference Check-in  
KC Marriott Downtown - Lobby

**6:00 PM -  
7:30 PM**

Top Golf KC - Overland Park  
*(optional transport from hotel provided)*

NSPMA Scholarship TopGolf Event  
Separate \$25 Registration Required  
with all proceeds benefitting the  
NSPMA Scholarship fund.

<https://nspma.com/event/nspma-april-26-2026-scholarship-fundraiser-top-golf-kc-mo/>

Travel can be exhausting, and we have a big day of learning and sharing ahead.

*"Rest is the key to fueling tomorrow's success— a well-rested mind is primed to embrace new ideas and opportunities."*

Sleep well everyone....

**Marriott Hotel  
(West Tower)**

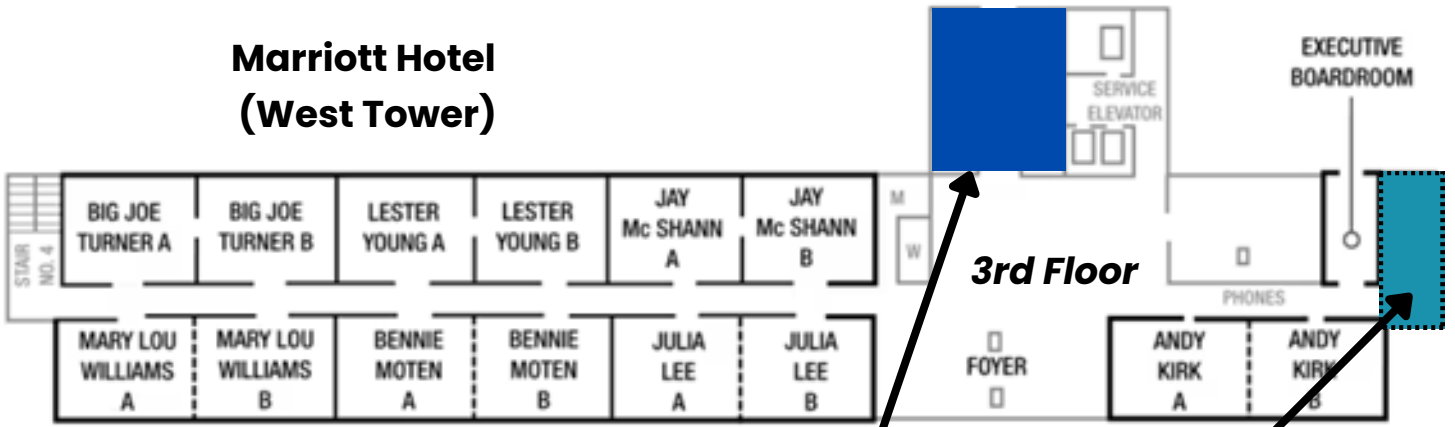

**3rd Floor**

**Marriott Hotel  
(West Tower)**

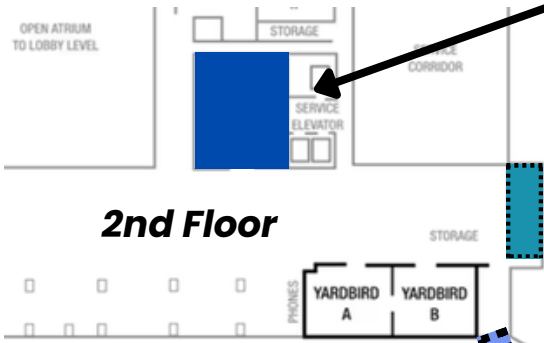

**2nd Floor**

*Elevators*

*Stairwell*

**Main Level Lobby  
Conference Center  
(East Tower)**

*Elevated Walkway  
between  
Buildings/Towers*

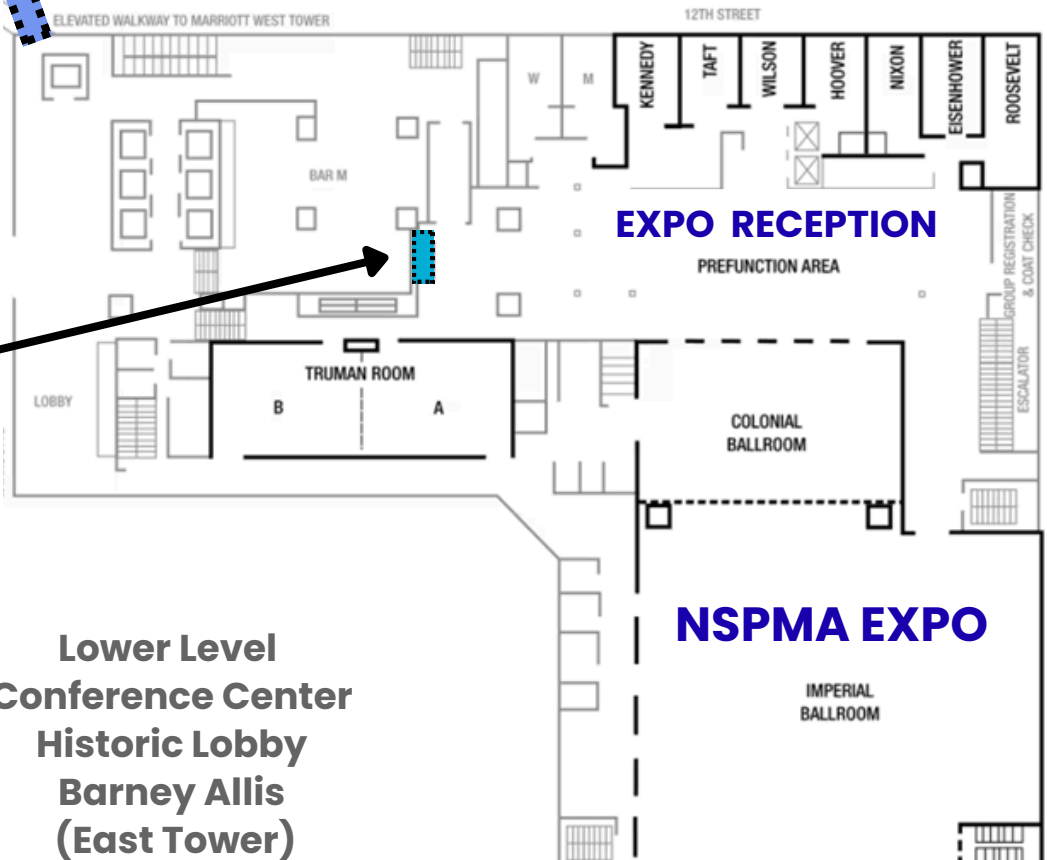

*Lower Level  
Stairwell to  
Barney Allis*

**Lower Level  
Conference Center  
Historic Lobby  
Barney Allis  
(East Tower)**

**Monday Attendee  
RECEPTION**

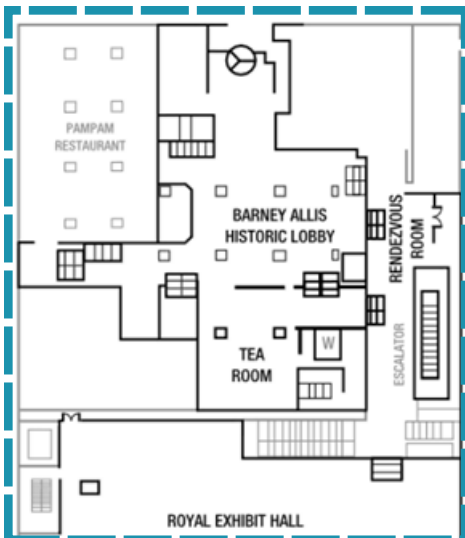

**EXPO RECEPTION**

**NSPMA EXPO**



# Program

**Monday April 27<sup>th</sup>**

**Day 2 - Explore**

**7:00 - 8:00 AM**

Conference Registration  
Marriott - East Tower (*Truman A/B Lobby*)

**7:00 - 8:00 AM**

Breakfast - (*Truman A/B*)

**8:00 - 8:30 AM**

Opening Address - (*Truman A/B*)  
Posting of the Colors: *Shawnee Mission North HS - NJROTC*

**8:30 - 9:00 AM**

**Keynote:**  
Resilience After Stroke; Overcoming Adversity,  
Reclaiming Purpose and Leading Through Recovery  
Anne Birky - OSFMA President

**9:00 - 9:15 AM**

Break

West Tower (Main Hotel)	<i>Andy Kirk A/B</i>	<i>Bennie Moten A/B</i>	<i>Julia Lee A/B</i>	<i>Kauffman Center</i>
<b>9:20 - 10:40 AM</b>	<b>Apalachee HS Active Shooter Debrief -</b> Travis Foster - ArmouredOne	<b>Employee Recruitment and Retention -</b> Rob Lamecker - Stillwater OK Schools	<b>Feedback That Fuels Growth: A Leader's Guide to Coaching -</b> Larin Davis - Ponka Schools - OK	<i>Group A - Tour</i>
<b>10:45 - 12:05 PM</b>	<b>Lockdown and Beyond</b> - Guy Grace - Partner Alliance Safe Schools	<b>Tell Me You're a Leader ... Without Telling Me You're a Leader -</b> Tracey Enger - Former EPA / Friend of NSPMA	<b>Boiler Room to the Boardroom -</b> Steffen Wiest - Neosho Schools (MO)	<i>Group B - Tour</i>

**12:10 - 1:00 PM Lunch - Truman A/B - (2nd Call for nominees)**

	Truman A/B	Colonial Ballroom
<b>1:00-2:20 PM</b>	<b>Leading Through Generations</b> Jim Vicar (NSPMA Legend) - Larin Davis Ponka Schools-OK Josh Peach (OpsHERO)	<b>School Physical Security by Design: Protecting Kids and the Culture of Learning. -</b> Guy Bliesner (Idaho School Safety) - David Sturtz (Sturtz & Co.)



# Program

## Monday April 27<sup>th</sup>

Day 2 – Explore (continued)

**Truman A/B** – All Attendees

**2:20 – 2:45 PM**

Afternoon Break  
Snack – Talk – Connect

**3:00 – 4:00 PM**

General Session / Share Out:  
Balancing Bricks, Budgets and People:  
The State of School Facilities

**4:00 – 4:30 PM**

NSPMA Annual Business Meeting

- Updates for leadership
- Proposed Bylaw ammendments (vote)
- Call for Board of Directors Nominees

**4:30 – 6:00 PM**

Attendee Opening Reception:  
*(Barney Allis –Historic Lobby – East Tower)*

**5:30 PM**

Scholarship / Awards Presentation

**6:00 PM**

Evening on Your Own – Dine Network and  
Discover Kansas City!

# Tuesday April 28

## Day 2 - Elevate

**7:30 - 8:30 AM**

Check-in / Breakfast  
(Truman A/B)

**8:30 - 9:00 AM**

Opening Address - Day 2  
Meet our Candidates

**9:10AM - 12:00PM**

Missouri Core - Certification Module #7  
(Adopted by: KS, TN, WI, OK) (Truman A/B)

**9:10AM - 12:00PM**

Day 2 - All Morning Breakout Sessions  
(Hotel West Tower 3<sup>rd</sup> Floor)  
\*full schedule next page

**9:30AM - 2:00PM**

*While They're in Sessions... You Get Kansas City!  
Spouse/Guests' Excursion - Arabia Steamboat Museum  
w/ Lunch - 9:30 AM Departure Hotel Lobby*

**12:00 - 12:45 PM**

Lunch (Truman A/B)  
Attendees / Vendors

**12:45 - 1:15 PM**

Announce Election Results - New  
President's Address

**1:30 - 5:00 PM**

### **Expo Floor: Discover, Connect, Grow**

Visit vendor/partners to explore innovative solutions, connect with experts, and find tools to drive success. Don't miss this opportunity to stay ahead and build valuable partnerships!

**1:30 - 4:30 PM**

*OperationsHERO/ Learning Lab  
(Ballroom Prefunction area)*

**5:00 - 7:00 PM**

### **Attendee / Vendor Networking-Reception** (Ballroom Prefunction Area)

Where the expo ends and the connections begin. Move beyond the booth and into a relaxed setting where great conversations, and even better connections, come naturally.

**7:00 PM**

Closing Remarks - Enjoy Kansas  
City and see you in Denver 2027!

# Program



9:10 - 10:00 AM	<p><b>Andy Kirk A/B Design/Build</b></p> <p>Using Total Cost of Ownership (TCO) to make purposeful Interior selections  Fran Burrage  Tarkett</p>	<p><b>Julia Lee A/B Leadership</b></p> <p>Ideas to retain Critical Operations Staff  David Lyons Executive Director  KSPMA - Kentucky</p>	<p><b>Bennie Moten A/B Maintain</b></p> <p>The Economics and Truth about HVAC Asset Management w/ Assessment and Restoration  Tyler Peterson  Nicholas Novy  TREMCO</p>	<p><b>Mary Lou Williams A/B Future</b></p> <p>Embracing Technology and AI: How to Improve your team's efficiency &amp; effectiveness  Matt Pace  FMX</p>	<p><b>Jay McShan B</b></p> <p>USGBC Center for Green Schools – HVAC Change Lab – Focus Group</p>
10:10 - 11:00 AM	<p><b>Breathe Easy, Save Green: How Indoor Air Quality Goals Drive High-Performance Facilities and Budget Savings</b>  Richard Johnson  USGBC</p>	<p><b>Women In Leadership</b>  Rosie Burkhard  Joan Moore  Katie Granado (Ex.Dir.)  WAMOA Washington</p>	<p>Sustainability through roofing and leveraging public cooperative contracts  Jeremy Huffman  O'hara's Son Roofing  David Mabe  TIPS</p>	<p>The Future of Bldgs. Achieving Sustainability Outcomes through Data Driven Insights (AI)  Andrew Belair  Carrier</p>	<p>Master Easy Reporting to Secure K12 Facility Resources  Nolan Brill  Simone Kublin  Incident IQ</p>
11:10 AM - Noon	<p><b>Flooring Has Changed. Has Your Maintenance Strategy?</b>  Jim Toth Jr.  Mannington  Randy Roth  Hillyard</p>	<p><b>No Cost Solutions for Improved IAQ in Schools</b>  Molly Ryan  American Lung Assoc.</p>	<p>Reducing Insurance Costs Through Proactive Property Risk Management &amp; Disaster Preparedness in K-12 Schools  Carmen Martinez  CRC</p>	<p>Modernizing Tasks and Growing Talent: How Fac. Dept. Use Robotics and Mentorship to Help Close the Skilled Trades Gap  Elliot Echols  (Rich Township Sch. IL)</p>	

# NSPMA 2026 EXPO Floor

*KC Marriott Downtown  
Main Level Conference Center  
(East Tower)*

*Lunch Overflow*

**Imperial / Colonial Ballrooms**  
*Pre-Function Area*  
**Expo Reception**

**Truman A/B**  
*Lunch Area*

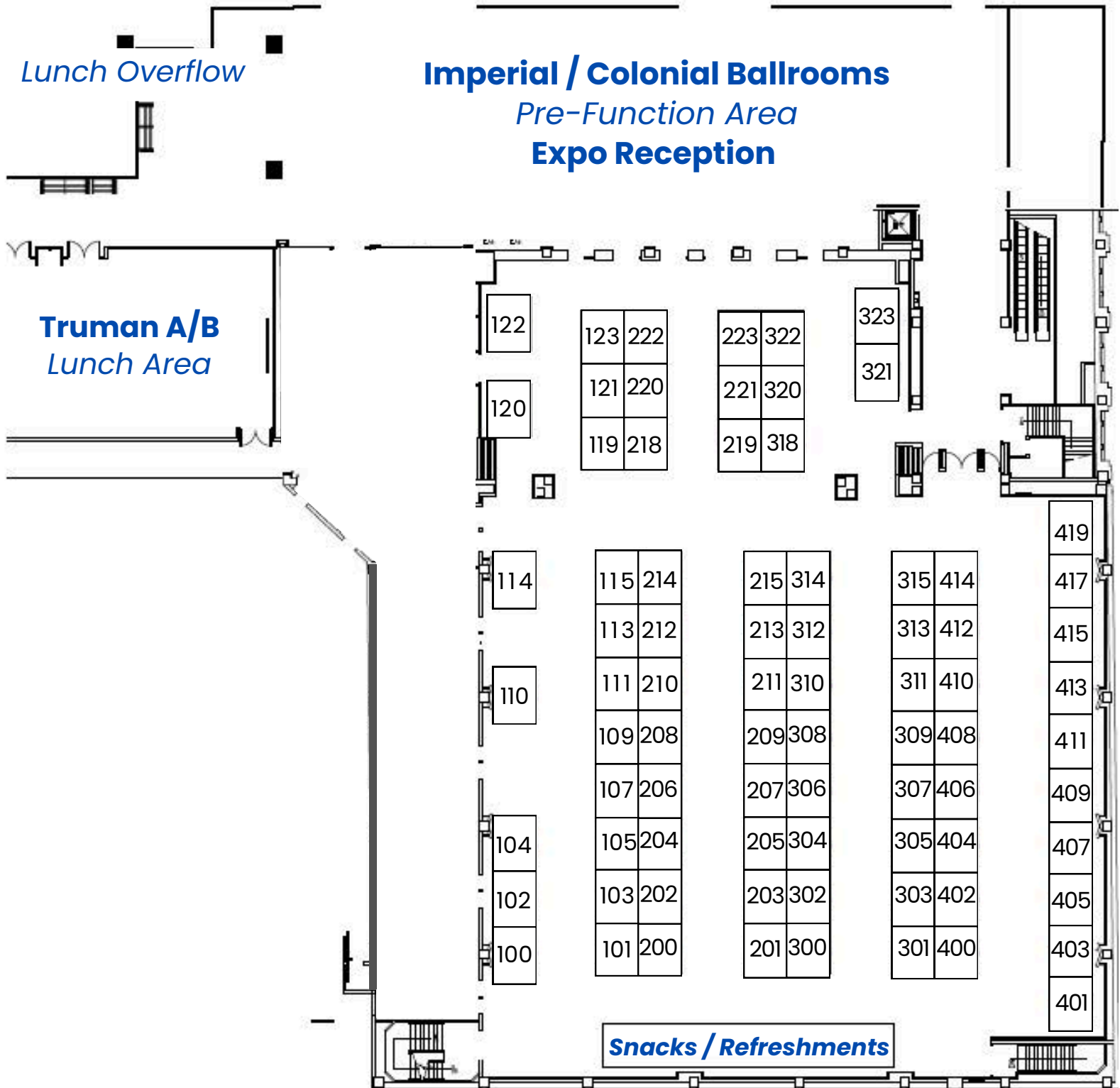

Exhibitor	Booth #	Exhibitor	Booth #	Exhibitor	Booth #
A-Lert Roof Systems	212	Follett	204	Pringle Robotics	402
A3 Communications / The Cook and Boardman Group	218	Forbo Flooring Systems	411	PROGRESSIVE MATERIALS (PM SILICONE)	113
ABB	207	Clorox - Purell (formerly GOJO)	100	Pur-O-Zone	404
Allegion	408	Gridbase (Formerly Map Your District)	208	Relay Pro	307
Ameripolish, Inc.	415	Hanwha Vision	314	Safe Haven Defense US	414
Armoured One, LLC	321	HD Supply	107	Sanipod Inc.	302
ASSA ABLOY	200	HES Facilities Management	320	Schneider Electric	409
ATHCO	308	Hillyard, Inc.	215	SIC Midwest	300
Attune	301	IMETCO (Garland)	202	SiteOne Landscape Supply	400
Brown & Root	115	Incident IQ	122	SofSURFACES	206
Byrne & Jones Construction	410	J&J Flooring Group	110	Spartan Chemical Company	306
Carrier	119 & 121	Kiefer USA	103	Special-Lite Inc	210
Clockworks Analytics	303	Mannington	214	Striem and Bulls-i Sales	417 & 419
Colibri Northwest Custom Publishing	104	McCownGordon Construction	304	Stryker	309
Convergent Technologies, LLC	312 & 310	Mechanical Systems Midwest	101	Sunbelt Rental	403
CRC - Commercial Restoration Company	223	MGT/Strong Glass Systems	213	Systemair	305
Delta Innovative Services Inc	315	Mid-America Sports Construction	109	Tarkett	123
Diamabrush	209	NetZero USA	120	Technical Environment Solutions LLC	413
Digital Scoreboard	105	New Age Casting	102	TIPS - USA	114
Duro-Last Roofing	407	Next Generation Recreation	211	TownSteel Inc.	111
Ecolab	205	Ohara's Son Roofing	323	Tremco Roofing and Building Maintenance	220
Enviroxclean	405	On-Site Drapery Cleaners	311	USGBC - Center for Green Schools	221
Fas-Trak Industries, Inc.	406	OperationsHERO	322	American Lung Association	221
First Onsite Property Restoration	203	Play & Park	219 & 318	Vector Solutions	313
FMX	222	Playground Guardian	412	Wesco	201



# Program

## **Wed. April 29**

State Associations Meeting  
Connect / Network / Support

### **9:00 AM - 11:00 AM**

*Truman A/B*

State Associations In Person Meeting  
(breakfast served 8:30 - 9:30)

Join fellow Executive Directors and Board Members for a candid, peer-led conversation about the real challenges of running a state non-profit facilities association. Using brief prompts and open discussion, we will surface shared pain points and explore what is – and is not – working across our organizations.

- Financial Sustainability & Funding
- Revenue mix, non-dues income, sponsorship volatility, and reserves
- Governance & Board Management
- Board engagement, term limits, ED-board dynamics, and accountability
- Membership Growth & Retention
- Value proposition, onboarding, and re-engaging silent members
- Shared problem solving and opportunity sharing

### **11:00 AM - 12:00 PM**

*Truman A/B*

NSPMA Board Meeting (closed meeting)



# 2026 EXPO Sponsors

## DIAMOND PARTNERS



**THE INTERLOCAL  
PURCHASING SYSTEM**  
"PURCHASING MADE SIMPLE"



## GOLD PARTNERS



**Mannington**  
COMMERCIAL



## EXPO BAG SPONSOR



## SILVER PARTNERS



## BRONZE PARTNERS



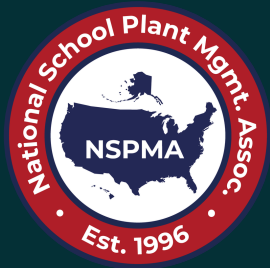

# 2026 NSPMA Top Golf Scholarship Sponsors





Every day, nearly 55 million students in the U.S. are exposed to mold, viruses, particulate matter, and other pollutants in school buildings where they spend half of their waking hours. Good indoor air quality (IAQ) in schools can improve health, improve academic performance and increase productivity.

K-12 schools nationwide can take action to improve their indoor environments by participating in the Clean Air School Challenge (CASC). CASC provides schools with a structured path to develop, implement and maintain an Energy Efficient Indoor Air Quality Management Plan, an effective tool in maintaining healthy indoor environments.

Whether a school is just beginning or has already developed a plan, CASC can help. CASC is designed to meet schools where they are in their journey of addressing indoor air quality, from assessment and planning through to implementation.

Learn more or sign up today at [Lung.org/CASC](https://Lung.org/CASC)

### Clean Air in Schools Makes Sense

Improving indoor air quality in school can:

- #1: Boost student attendance
- #2: Increase student and staff performance
- #3: Improve teacher retention and recruitment
- #4: Reduce dependence on substitute teachers
- #5: Improve longevity and operation of HVAC and other mechanical systems

...and it makes “cents” by saving your school money



### Sign up to access these benefits:

- Education and Training
- Recognition
- Technical Assistance
- Peer Mentorship
- Mini-grants\*
- Learning Cohorts\*
- Access to other Lung Association Programs

\*application process



This project has been funded in its entirety by the United States Environmental Protection Agency under assistance agreement #84098901 (CFDA 66.034) to the American Lung Association. The contents of this document do not necessarily reflect the views and policies of the Environmental Protection Agency, nor does the EPA endorse trade names or recommend the use of commercial products mentioned in this document.



The **National Center on School Infrastructure** is a national resource hub that supports states and school districts in the stewardship of America's elementary and secondary public school facilities.

Our comprehensive resource library offers easy access to high-quality guidance and practical tools for building, maintaining, and improving school buildings and grounds. Additionally, it centralizes state policies and facilities data, enabling informed decision-making at the federal, state, and local levels.

**Check out our resource library for:**

- Tools
- Research
- Policy
- Reports
- Data sets
- News
- Case studies

**RESOURCE SPOTLIGHT**

## **NCSI Tools for Conducting Facility Condition Assessments**

This Facility Condition Assessment (FCA) Manual provides guidance for conducting FCAs, including action steps for assessing exterior and interior conditions, as well as mechanical, electrical, and plumbing systems. The accompanying Excel-based FCA Workbook is a tool for compiling and analyzing building data.

Read the article:



[school-infrastructure.org](https://school-infrastructure.org)





# TIPS-USA

The Interlocal Purchasing System  
Cooperative Purchasing Made Simple

PROUD SUPPORTER  
NSPMA 2025-26

## Streamline Your Purchasing. Maximize Your Value.

TIPS-USA is a national cooperative purchasing program trusted by thousands of public agencies across the country.

### For Buyers

Access pre-vetted contracts without an RFP process.

Schools · Cities · Agencies  
Nonprofits · Universities

### For Vendors

Become an approved TIPS contractor and reach thousands of agencies.

Grow your public market

### Compliant & Easy

Contracts meet all state and federal bid law requirements.

Fully transparent process

## Why TIPS-USA?

- ✓ No cost for qualifying agencies
- ✓ Competitive pricing pre-negotiated
- ✓ Hundreds of active contracts
- ✓ National reach — all 50 states
- ✓ Open to schools, govt & nonprofits
- ✓ Award-winning vendor support

Learn more about buying off or being part of a TIPS-USA contract:

[www.tips-usa.com](http://www.tips-usa.com)

TIPS-USA proudly thanks NSPMA for their continued support and partnership.



# NSPMA Website Launch

A new digital home built specifically for public school facilities professionals — featuring exclusive member resources, peer connection, and professional development.

YOUR MEMBERSHIP JUST GOT MORE POWERFUL

NSPMA is proud to unveil a completely redesigned website — featuring an exclusive members-only portal with direct access to the tools, training, and community your facility's team needs to perform at its best.



### Member Directory

Connect with facilities professionals across the country. Search by region, district size, or expertise to find the right peers and mentors.



### Training & Courses

On-demand professional development tailored for school facilities teams — from custodial operations and preventive maintenance to leadership and compliance training.



### Discussion Forums

Engage in facilitated peer conversations around real challenges — from budget cycles and maintenance planning to safety compliance and staff development.



### Resources Library

Access templates, policy guides, best practices, and curated tools — all developed with public school facilities operations in mind.



**NSPMA 2027 Denver Colorado**  
**Hilton Denver City**  
**May 2<sup>nd</sup> — May 5<sup>th</sup>**